

E-PTO type CM22 120180U

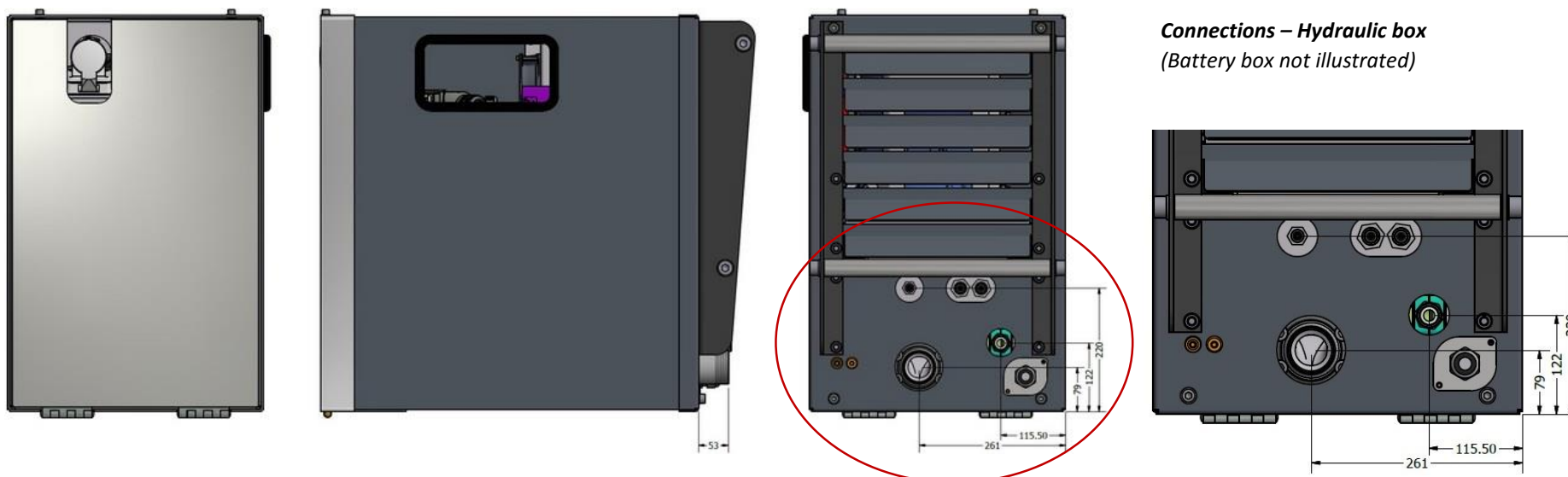



Connections – Hydraulic box
(Battery box not illustrated)

Technical specifications – E-PTO type CM22 120180U

– all specifications are subject to change without further notice – 29 April 2016

Power Levels, E-motor	0-30 kW, continuously, peak power 45 kW	AC Installation Requirements	3*400V AC 50 Hz, standard 5 pole 16A CEE- plug with RCD
Battery Technology	LiFePO ₄	24V Supply from ignition key	16-32 VDC max 5A. Protection requirement, 10A fuse
Battery Lifetime	2000 full cycles	Hydraulic Interface	Variable displacement load sensing pump
Battery Heating	Electric 400W forced air, to enable full charging capacity – even at low temperatures	Temperature Range	-20°C to +45°C (above 35°C power derating possible)
Battery Voltage	80-115V	Cooling	Forced air
Battery Cell Protection	Balancing and active protection on all cells	IP-grade	IP65, allowing high-pressure wash down. Note: high-pressure wash down not allowed directly in charging connector, IP44
Battery Pack Protection	Fully protected against overcurrent, over-, and under-voltage, excessive temperature use and charging	Dimensions Hydraulic box (L,W,H)	457 mm, 783 mm, 727 mm Note: Excl. hydraulic connections & cable entries
Motor Technology	AC motor with variable closed loop RPM control	Dimensions Battery Box (L, W, H)	833 mm, 690 mm, 727 mm Note: Excl. cable entries
Control Interface	Either CAN, analogue, PWM, or I/O	Weight Hydraulic box	170 kg
Charging	On-board 3 kW, 230V AC	Weight Battery box	325 kg
Charging Time	7-9 hours	Options	Charge current reduction